

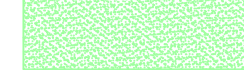







LEGENDA

-  FUNZIONI COMMERCIALI / TERZIARIE
-  SUPERFICIE PERMEABILE
-  PIAZZA
-  MARCIAPIEDE
-  PISTA CICLABILE
-  LIMITE D'INTERVENTO "Contesti per servizi di nuovo impianto (art.27 PUG/P)"

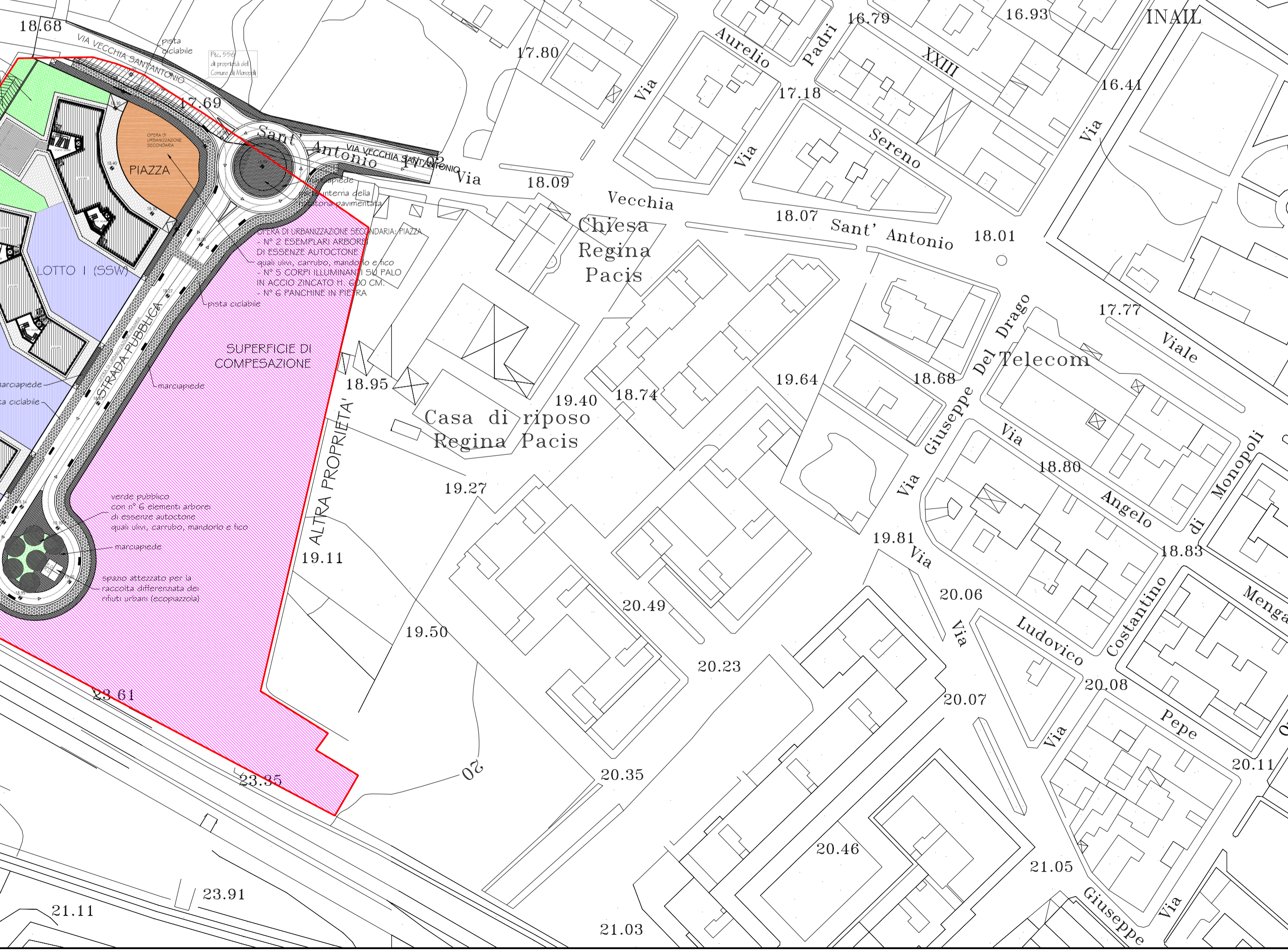
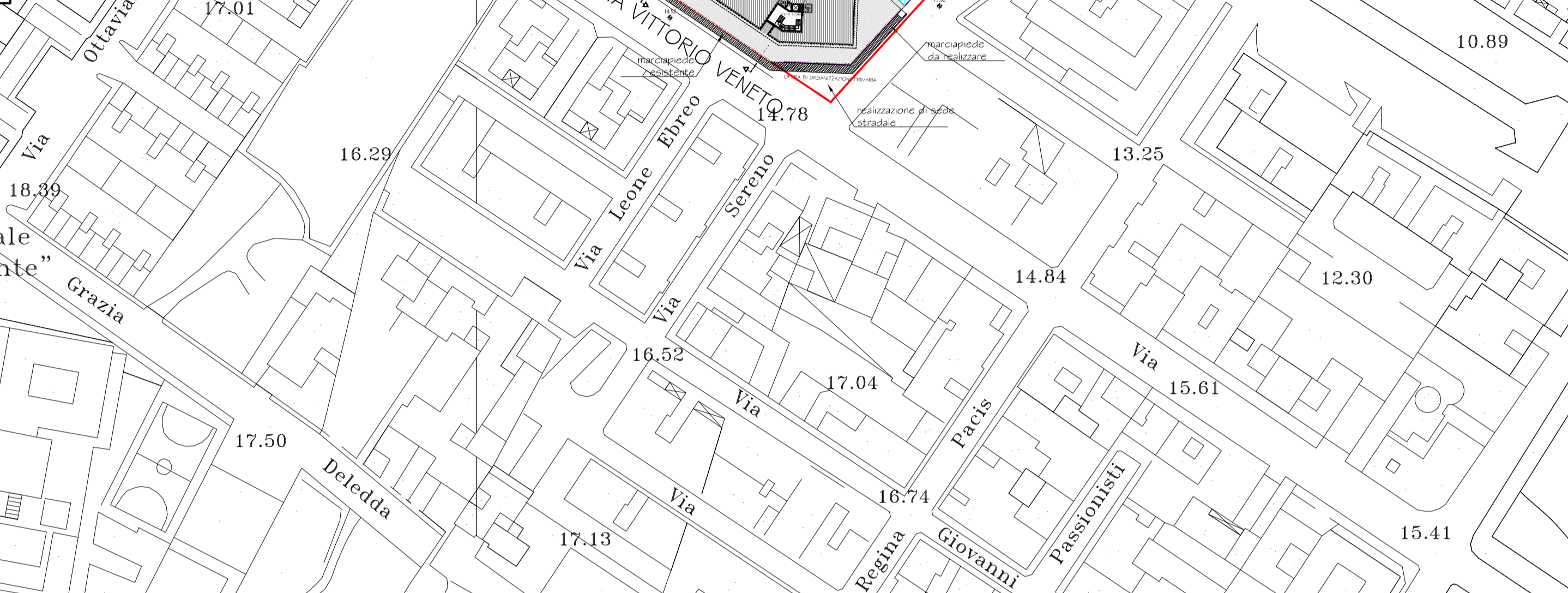
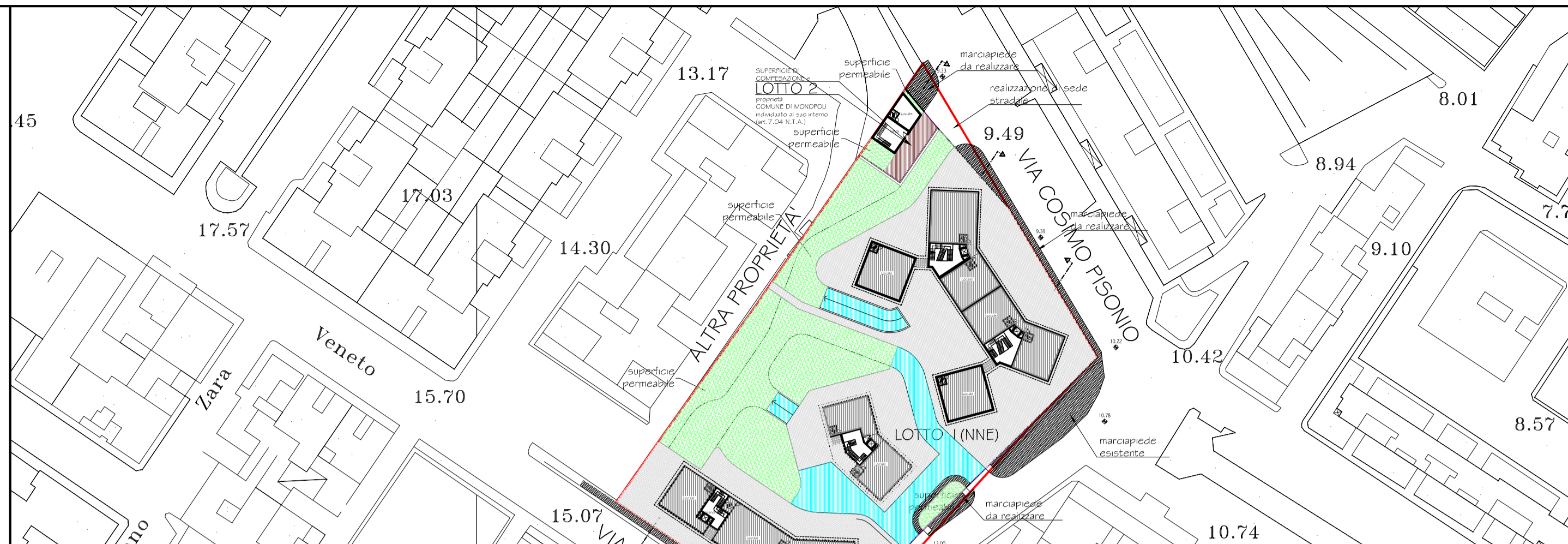
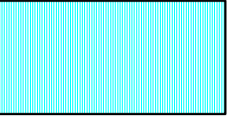
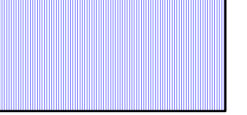

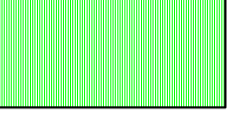
LEGENDA

-  LOTTO 1 (NNE) Sf mq= 7222,00
-  LOTTO 1 (SSW) Sf mq= 7626,00
-  LOTTO 2 Sf mq= 210,00
-  LOTTO 3 Sf mq= 420,00
-  SUPERFICIE DI COMPESAZIONE SC mq= 15548,00
-  LIMITE D'INTERVENTO "Contesti per servizi di nuovo impianto (art.27 PUG/P)"

} mq= 14848,00

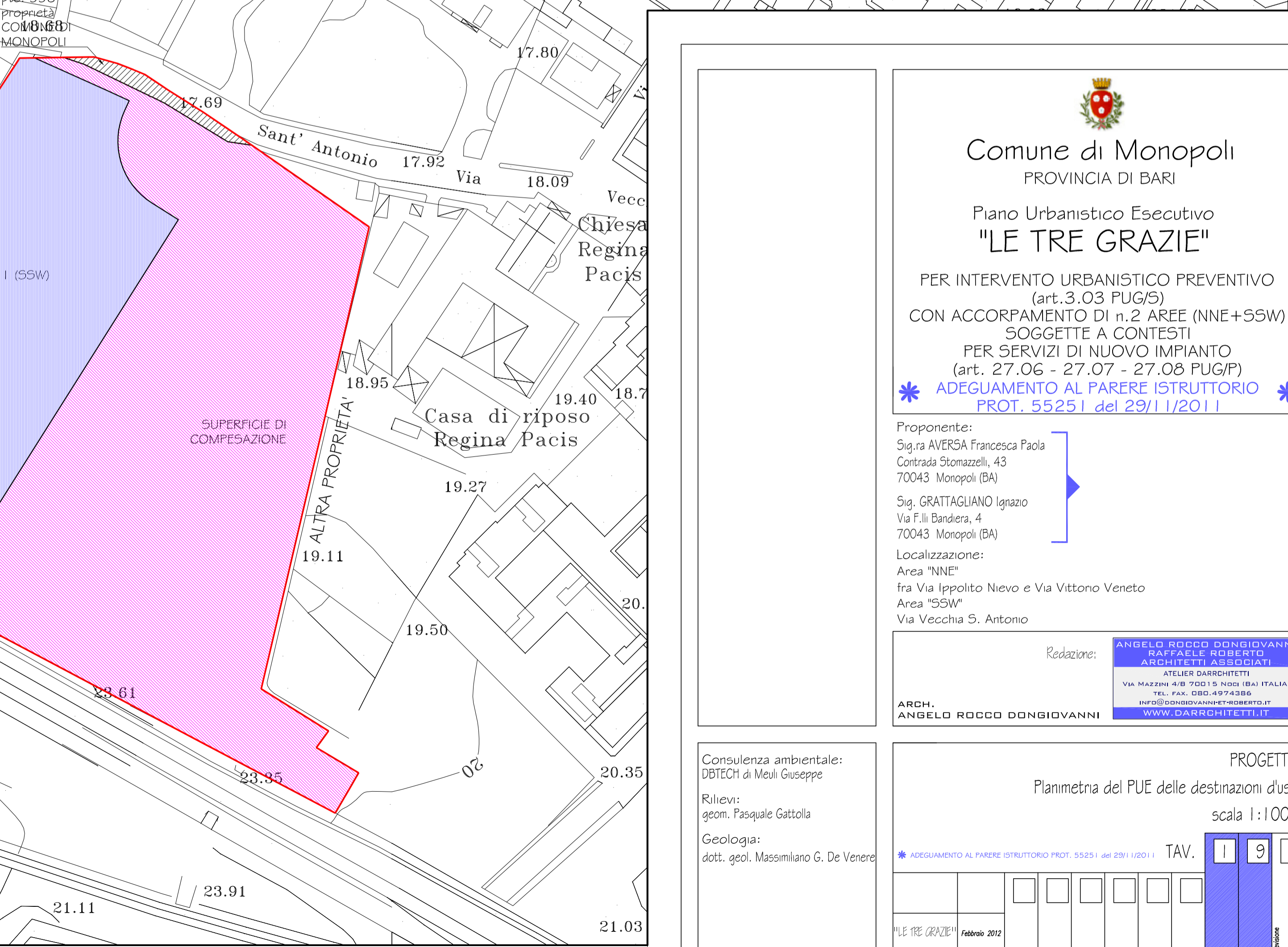
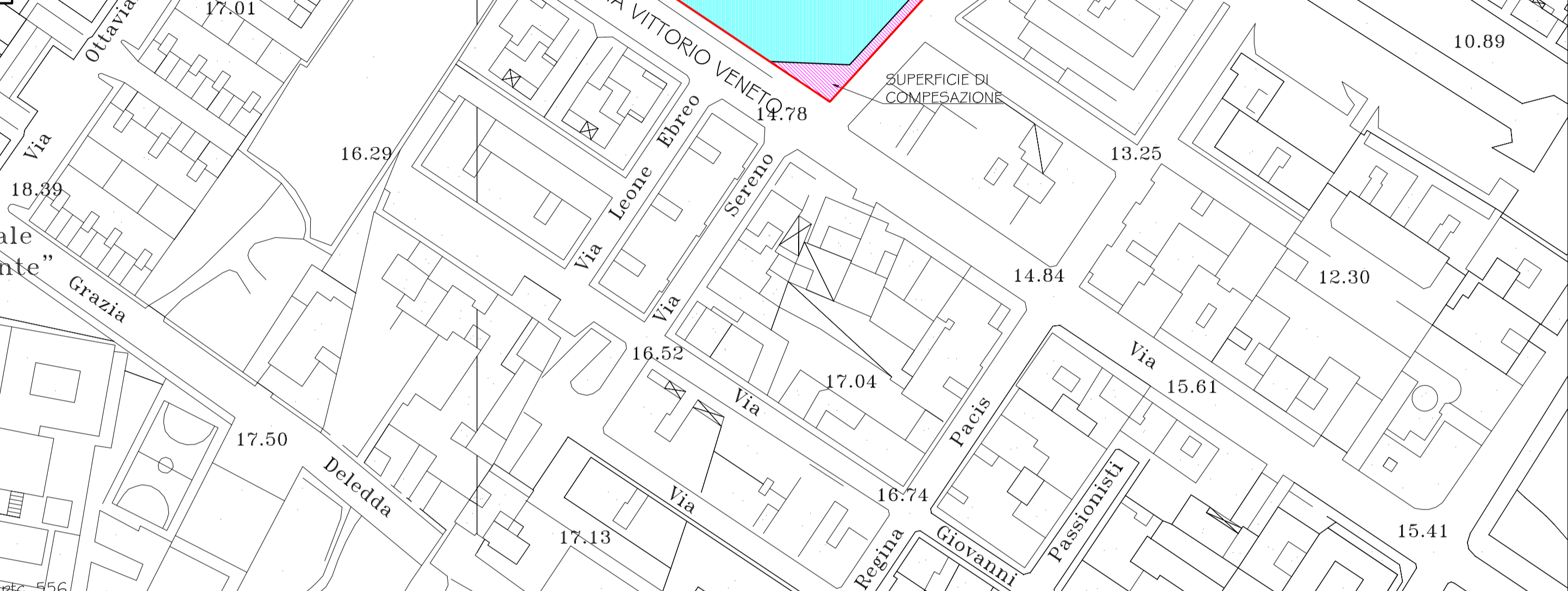
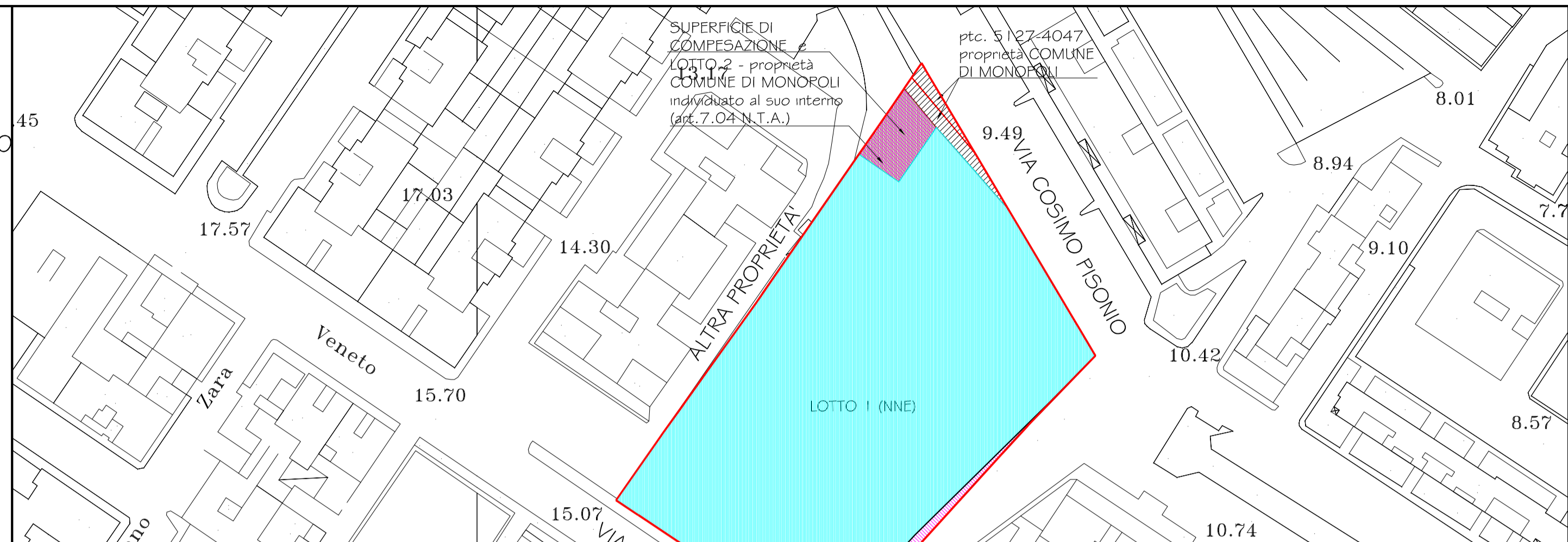



Comune di Monopoli
PROVINCIA DI BARI

Piano Urbanistico Esecutivo
"LE TRE GRAZIE"

PER INTERVENTO URBANISTICO PREVENTIVO
(art.3.03 PUG/5)
CON ACCORPAMENTO DI n.2 AREE (NNE+SSW)
SOGGETTE A CONTESTI
PER SERVIZI DI NUOVO IMPIANTO
(art. 27.06 - 27.07 - 27.08 PUG/P)
*** ADEGUAMENTO AL PARERE ISTRUTTORIO PROT. 55251 del 29/11/2011 ***

Proprietà:
Sig.ra AVERSA Francesca Paola
Contrada Stomazzelli, 43
70043 Monopoli (BA)

Sig. GRATTAGLIANO Ignazio
Via F.lli Bandiera, 4
70043 Monopoli (BA)

Localizzazione:
Area "NNE"
fra Via Ippolito Nievo e Via Vittorio Veneto
Area "SSW"
Via Vecchia S. Antonio

Redazione:
ANGELO ROCCO DONGIOVANNI
RAFFAELE RIBERTO
ARCHITETTI ASSOCIATI
ATELIER SANGIUSEPPI
VIA MAZZINI 4/B 70015 NOCI (BA) ITALIA
TEL. FAX. 0884-8774308
INFO@DONGIOVANNIARCHITETTI.IT
WWW.DARCHITETTI.IT

Consulenza ambientale:
DBTECH di Meuli Giuseppe

Rilievi:
geom. Pasquale Gattola

Geologia:
dott. geol. Massimiliano G. De Veneris

PROGETTO
Planimetria del PUE delle destinazioni d'uso
scala 1:1.000

* ADEGUAMENTO AL PARERE ISTRUTTORIO PROT. 55251 del 29/11/2011 * TAV. 1 9

"LE TRE GRAZIE" Febbraio 2012